

REMER

RUBINETTERIE

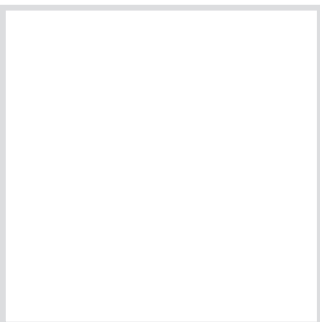
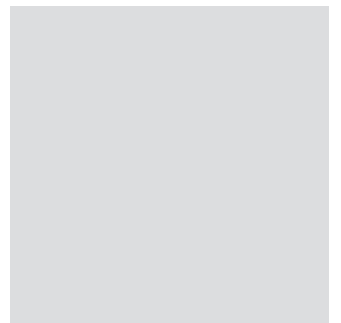
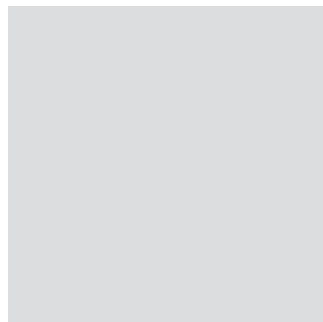
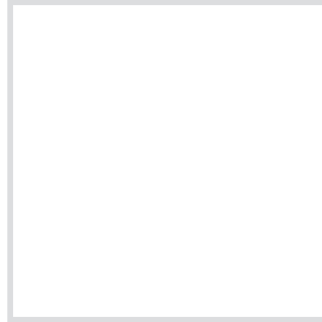

MADE IN ITALY 

LISTINO PREZZI MINUTERIA

MINUTERY PRICE LIST

18-19

REMER

RUBINETTERIE

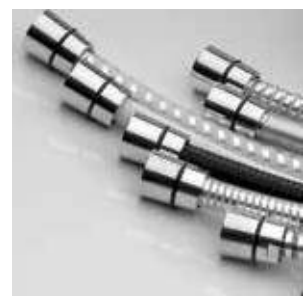
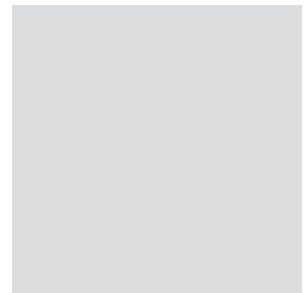
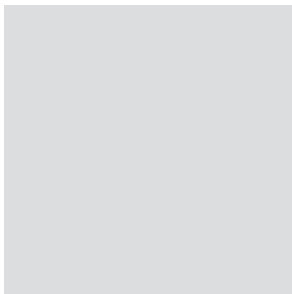

MADE IN ITALY 

LISTINO PREZZI MINUTERIA

MINUTERY PRICE LIST

18-19

REMER

LA FORZA DI UN GRANDE GRUPPO
THE STRENGTH OF A BIG GROUP

Pulitura, Controllo qualità,
Pre-assemblaggio,
Stampaggio plastico, Logistica.
Polishing department, Test department,
Pre-assembly department,
Injection plastic pressing department,
Logistic department.

Sede operativa e
Head office factory.

ENGINEERING 2
produzione
high-tech
high-tech
production.

REMER
STORE

ENGINEERING 1
produzione high-tech
high-tech production.

 **FLEXITALY**
produzione
flessibili
flexible hoses
production.



Cassano d'Adda (MI) - Italy
Lat: 45° 31' 37" N Long: 9° 30' 11" E

sede storica
hystorical factory



REMER sede operativa e uffici amministrativi.

REMER main factory and offices.



REMER ENGINEERING 1 produzione high-tech, R&D.

REMER ENGINEERING 1 high-tech production, R&D.



REMER ENGINEERING 2 produzione high-tech.

REMER ENGINEERING 2 high-tech production.



REMER Pulitura. Controllo qualità, Pre-assemblaggio, Stampaggio plastico, Logistica.

REMER Polishing department, Test department, Pre-assembly department, Injection plastic pressing department, logistic center.



FLEXITALY: produzione flessibili.

FLEXITALY: production of flexibles.

OUR STRENGTH

LA NOSTRA FORZA È DETERMINATA
DA DIVERSI FATTORI:

OUR STRENGTH IS DETERMINED
BY MANY FACTORS:

- Produzione interna di articoli fusi, stampati, da barra, da lastra e da tubo di ottone
 - Produzione interna di componenti in plastica
 - 100% prodotto testato e garantito
 - Linee di assemblaggio automatiche
 - Tutta la produzione, l'assemblaggio e la logistica automatizzata, robotizzata e computerizzata
 - Rapidità di consegna e disponibilità costante del prodotto
 - Produzione interna di svariate componentistiche incluse cartucce, vitoni, flessibili, deviatori e molto altro
 - 100% ciclo di produzione interno incluse pulitura e cromatura e verniciatura
 - 100% materia prima di qualità per un prodotto conforme
 - Circa 100 postazioni in radio frequenza
 - Produzione interna di packaging
 - Assistenza vendite e post vendita con servizio di qualità
- Internal production of casted, forged, brass bar, sheet, brass tube items
 - Internal production of plastic components
 - 100% tested, guaranteed and risk free products
 - Automatic test and assembly lines
 - The entire production, assembly and logistics is automated, robotic and computerized
 - Quality sales and post-sales assistance
 - Internal production of several components included cartridges, headvalves, flexibles, diverters and many more
 - 100% internal product cycle including both polishing, chrome plating and spray pain process
 - 100% quality raw material, risk free and conform products
 - Around 100 positions of computers in radio frequency
 - Internal packaging production
 - Quick delivery and constant availability of the product



OUR CERTIFICATIONS:

Remer Rubinetterie S.p.A. è un'azienda certificata UNI EN ISO 9001:2008 sistema di gestione qualità aziendale e UNI EN ISO 14001: 2004 per l'impatto ambientale.

Remer Rubinetterie S.p.A. is a UNI EN ISO 9001:2008 certified factory for the quality system and UNI EN ISO 14001: 2004 for environmental impact.





RR[®]
REMER RUBINETTERIE

VALVOLE VALVES



VALVOLE - VALVES

MINUTERIA
MINUTERY

VALVOLE
VALVES

RACCORDERIA
FITTINGS

ACCESSORI
ACCESSORIES

COMPONENTI PLASTICI
PLASTIC COMPONENTS

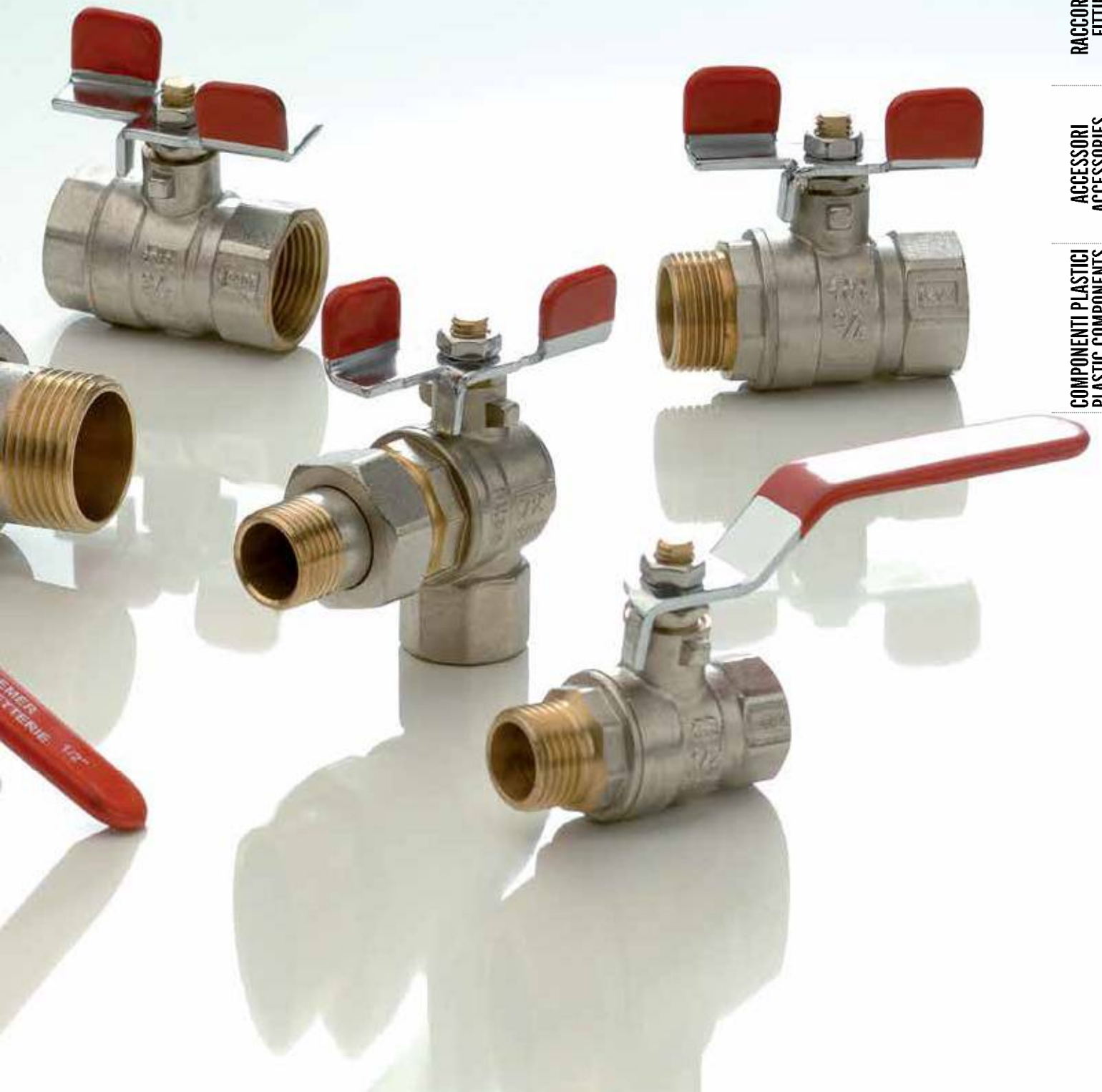

SEVEN SERIE

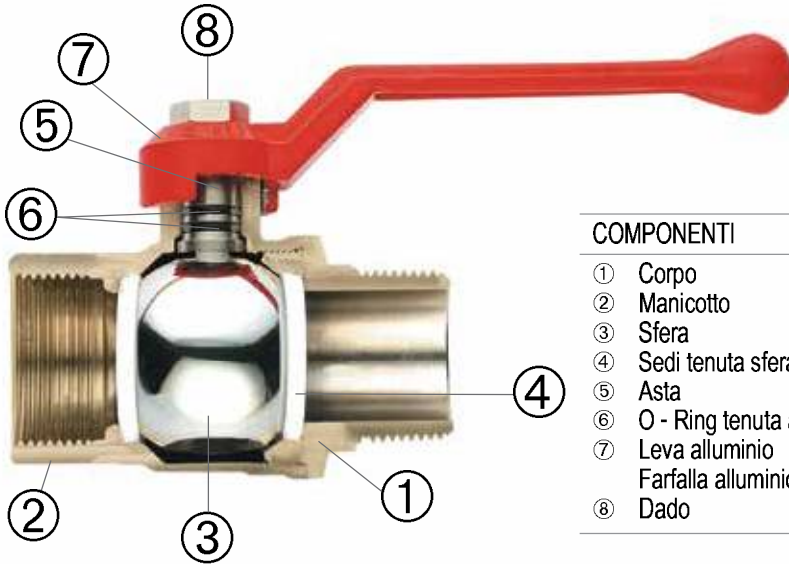

COMPONENTI	COMPONENTS	MATERIALI - MATERIALS
① Corpo	① Body	UNI EN 12165 CW617N
② Manicotto	② End connection	UNI EN 12165 CW617N
③ Sfera	③ Ball	UNI EN 12165 CW617N
④ Sedi tenuta sfera	④ Ball seal	P.T.F.E.
⑤ Asta	⑤ Stem	UNI EN 12164 CW614N
⑥ O - Ring tenuta asta	⑥ Rod seal O - Ring	NBR 70 Sh A (ASTM D 2240)
⑦ Leva alluminio	⑦ Alu handle	AL fire painted
Farfalla alluminio	Butterfly handle	AL fire painted
⑧ Dado	⑧ Nut	Chrome plated Brass

Condizioni d'esercizio: Temperatura: min -15, max +120 - Pressione nominale: max 40 bar.

Working details: Temperature: min -15, max +120 - Nominal pressure: max 40 bar.

- Passaggio: totale
- Gamma: da 1/2" a 2"
- Attacco femmina: filettatura ISO 7/1 Rp (parallela) (DIN 2999)
- Attacco maschio: filettatura ISO 7/1 R (conica) (DIN 2999)
- Codolo e dado: filettatura ISO 228/1 (DIN 259)

- Flow: full
- Range: from 1/2" till 2"
- Female thread: threading ISO 7/1 R (parallel) (DIN 2999)
- Male thread: threading ISO 7/1 R (conical) (DIN 2999)
- Connection fitting and nut: threading ISO 228/1 (DIN 259)

Diagramma perdite di carico/portata
Load losses/flow rate graph

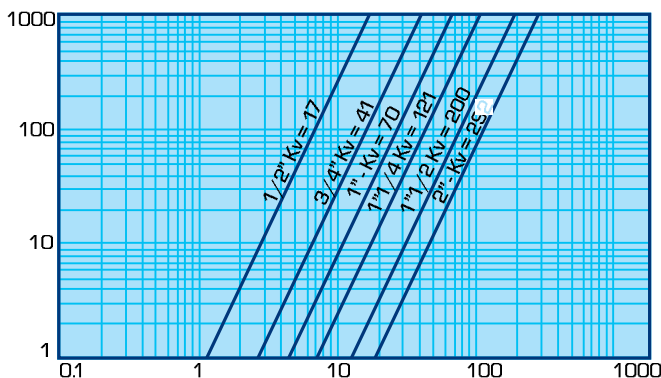

Portata = m³/h di Acqua
Water flow rate = m³/h

Diagramma pressione/temperatura
Pressure/temperature graph

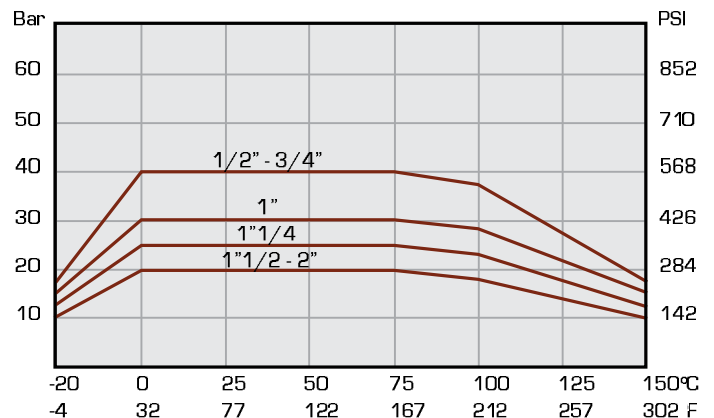

VALVOLE - VALVES

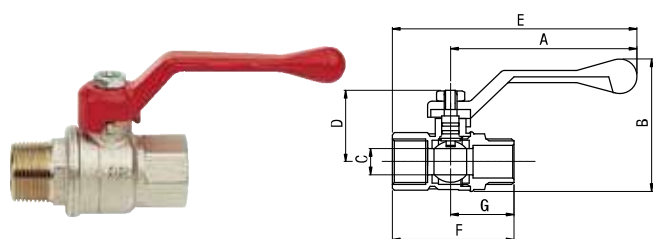

360 MF 1/2" € 6,70 3/4" € 10,20 1" € 14,90
 1 1/4" € 26,40 1 1/2" € 35,00 2" € 54,00

Valvola a sfera M.F. a sette filetti, a passaggio totale, maniglia a leva.
 C.P. full-flow ball valve "seven threads" M.F., with lever handle.

	A	B	C	D	E	F	G
1/2"	84,5	66	15	36,5	115,5	68	38,3
3/4"	110	74	20	43,5	134	76	42,3
1"	110	82,5	25	47	140	87	48
1 1/4"	140	101,5	32	60	188	106	58
1 1/2"	140	112	40	65,5	192,5	114	61,5
2"	170	139,5	50	79	222,5	136,5	73,5

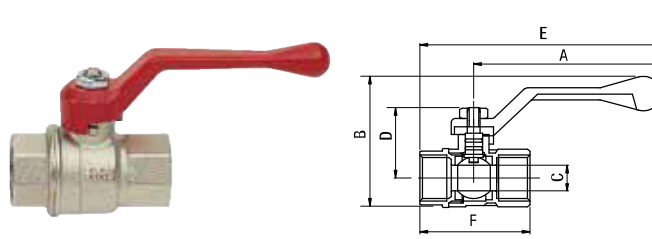

360 FF 1/2" € 6,40 3/4" € 9,50 1" € 14,30
 1 1/4" € 24,40 1 1/2" € 34,10 2" € 53,30

Valvola a sfera F.F. a sette filetti, a passaggio totale, maniglia a leva.
 C.P. full-flow ball valve "seven threads" F.F., with lever handle.

	A	B	C	D	E	F	G
1/2"	84,5	66	15	36,5	115,5	59,5	59,5
3/4"	110	74	20	53	134	67,5	67,5
1"	110	82,5	25	47	140	79	79
1 1/4"	140	101,5	32	60	188	96	96
1 1/2"	140	112	40	65,5	192,5	105	105
2"	170	139,5	50	79	222,5	126	126

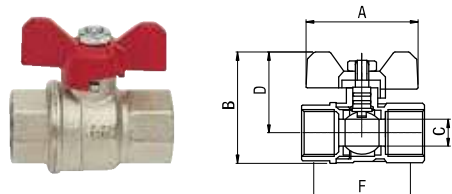

361 FF 1/2" € 6,40 3/4" € 9,50 1" € 14,30

Valvola a sfera F.F. a sette filetti, a passaggio totale, maniglia a farfalla.
 C.P. full-flow ball valve "seven threads" F.F., with T handle.

	A	B	C	D	E	F	G
1/2"	51,5	54,5	15	38,5		59,5	
3/4"	63	66,5	20	47		67,5	
1"	63	75	25	51		79	

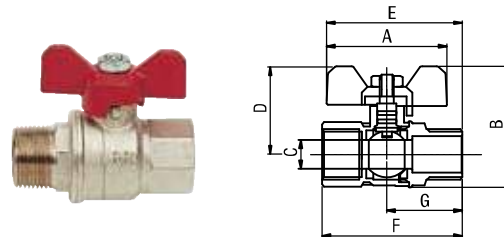

361 MF 1/2" € 6,70 3/4" € 10,20 1" € 14,90

Valvola a sfera F.F. a sette filetti, a passaggio totale, maniglia a farfalla.
 C.P. full-flow ball valve "seven threads" F.F., with T handle.

	A	B	C	D	E	F	G
1/2"	51,5	54,5	15	38,5	64,1	68	38,3
3/4"	63	66,5	20	47	73,8	76	42,3
1"	63	75	25	51	79	87	48

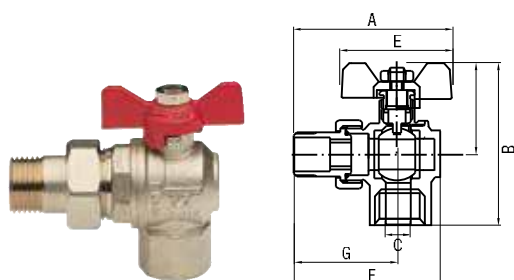

364 C 1/2" € 8,30 3/4" € 13,00 1" € 22,80

Valvola a sfera ad angolo a sette filetti, con bocchettone, passaggio totale, maniglia a farfalla.

C.P. full-flow angle ball valve "seven threads", with union connection, with T handle.

	A	B	C	D	E	F	G
1/2"	87	53	15	37,5	51,5	91	61,5
3/4"	96,5	62,5	20	43,5	62	99	66,5
1"	109,5	70	25	46,5	62	118	78,5

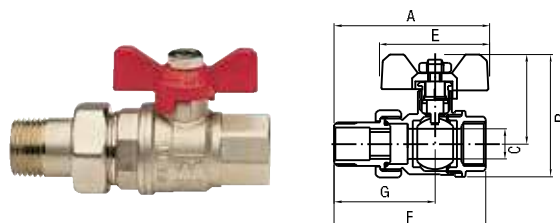

364 1/2" € 7,90 3/4" € 12,60 1" € 21,00

Valvola a sfera a sette filetti, con bocchettone, passaggio totale, maniglia a farfalla.

C.P. full-flow ball valve "seven threads", with union connection, with T handle.

	A	B	C	D	E	F	G
1/2"	84	69,5	13,8	38	51,5	74,5	58,5
3/4"	96,5	81,5	18,5	45	62	85,5	66
1"	111,5	93	23	48	62	103,5	80

MINUTERIA
MINUTERY

VALVOLE
VALVES

RACCORDERIA
FITTINGS

ACCESSORI
ACCESSORIES

COMPONENTI PLASTICI
PLASTIC COMPONENTS

RR SERIE

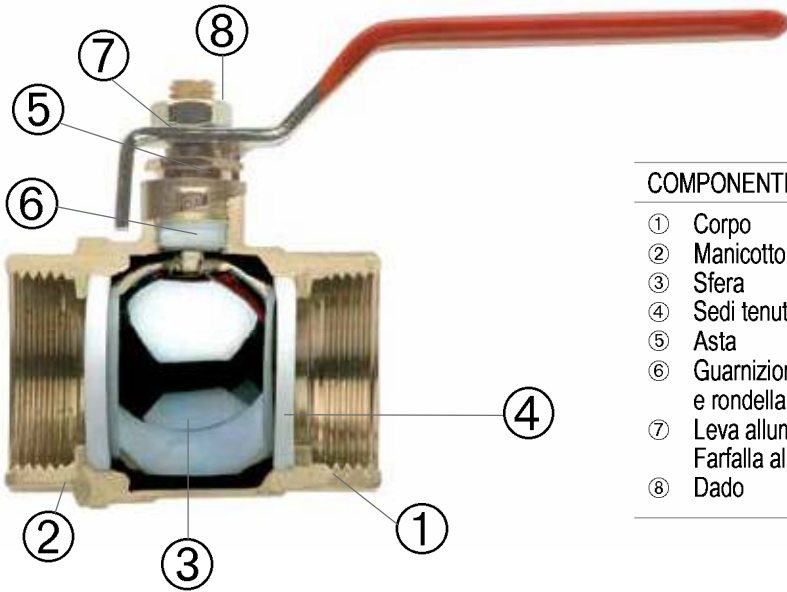

COMPONENTI	COMPONENTS	MATERIALI - MATERIALS
① Corpo	① Body	UNI EN 12165 CW617N
② Manicotto	② End connection	UNI EN 12165 CW617N
③ Sfera	③ Ball	UNI EN 12165 CW617N
④ Sedi tenuta sfera	④ Ball seal	P.T.F.E.
⑤ Asta	⑤ Stem	UNI EN 12164 CW614N
⑥ Guarnizioni tenuta asta e rondella antifrizione	⑥ Stem packing and antifriction ring	P.T.F.E.
⑦ Leva alluminio	⑦ Alu handle	AISI A3 PVC cover
⑧ Dado	⑧ Nut	Butterfly handle AISI A3 PVC cover Chrome plated Brass

Condizioni d'esercizio: Temperatura: min -15, max +120 - Pressione nominale: max 40 bar.

Working details: Temperature: min -15, max +120 - Nominal pressure: max 40 bar.

- Passaggio: totale
- Gamma: da 1/2" a 2"
- Attacco femmina: filettatura ISO 228/1 (DIN 259)
- Attacco maschio: filettatura ISO 228/1 (conica) (DIN 259)
- Codolo e dado: filettatura ISO 228/1 (DIN 259)

- Flow: full
- Range: from 1/2" to 2"
- Female thread: threading ISO 228/1 (DIN 259)
- Male thread: threading ISO 228/1 (DIN 259)
- Connection fitting and nut: threading ISO 228/1 (DIN 259)

Diagramma perdite di carico/portata
Load losses/flow rate graph

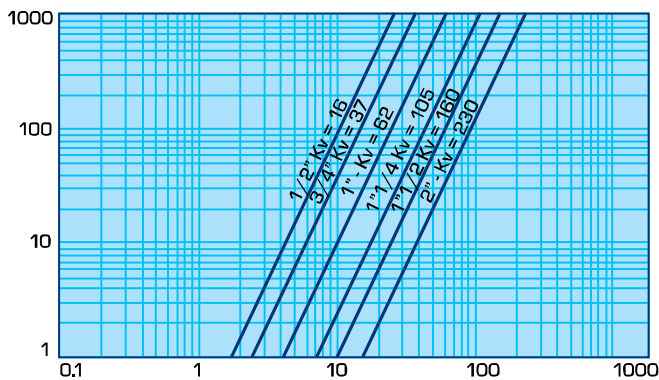

Portata = m³/h di Acqua
Water flow rate = m³/h

Diagramma pressione/temperatura
Pressure/temperature graph

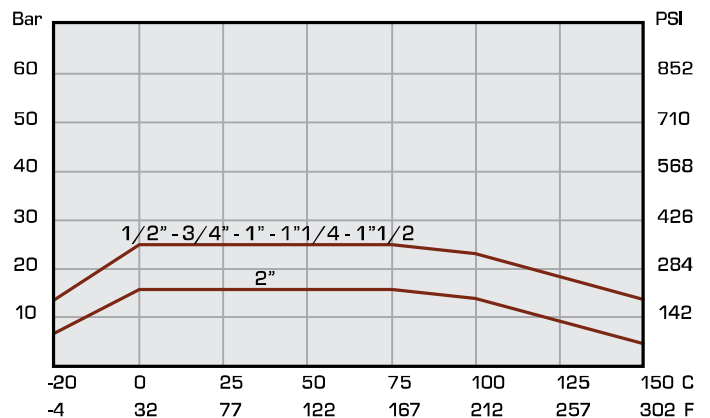

VALVOLE - VALVES

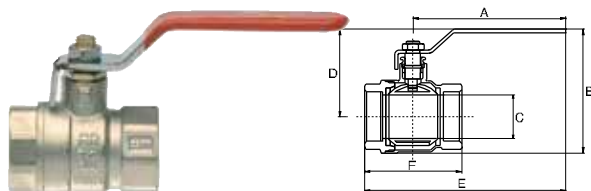

371 RR 1/2 €5,00 3/4 €7,00 1" €11,80 1 1/4 €18,30
 1 1/2 €27,60 2" €38,10 2 1/2 €87,70 3" €113,10 4" €208,80

Valvola a sfera F.F. a passaggio totale, maniglia a leva, linea pesante e ottone visibile.
 C.p. full-flow RR ball valve F.F., heavy line and visible brass with lever handle.

	A	B	C	D	E	F	G
1/2"	95	65	14,5	50	120	48	
3/4"	95	68	18,5	53	124	55	
1"	125	80	23	62	155	63	
1" 1/4	125	97	31,5	69	165	78	
1" 1/2	138	110	31,5	80	180	87	
2"	165	125	50	86	210	100	
2" 1/2	236		62	117	306	140	
3"	225		73	130	330	150	
4"	225		79	142,5	350	190	

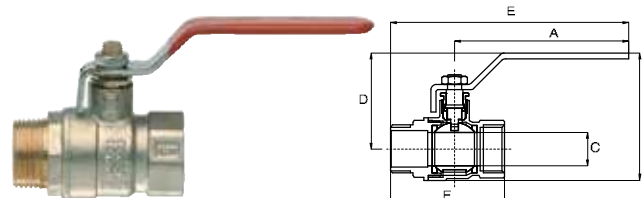

370 RR 1/2 €5,50 3/4 €7,40 1" €12,80
 1 1/4 €19,70 1 1/2 €28,50 2" €41,80

Valvola a sfera M.F. a passaggio totale, maniglia a leva, linea pesante e ottone visibile.
 C.p. full-flow RR ball valve M.F. heavy line and visible brass with lever handle.

	A	B	C	D	E	F	G
1/2"	95	65	14,5	50	120	63	
3/4"	95	68	18,5	53	130	63	
1"	125	80	23	62	165	72	
1" 1/4	125	97	31,5	69	175	87	
1" 1/2	138	110	31,5	80	195	97	
2"	165	125	50	86	220	110	

MINUTERIA
MINUTERY

VALVOLE
VALVES

RACCORDERIA
FITTINGS

ACCESSORI
ACCESSORIES

COMPONENTI PLASTICI
PLASTIC COMPONENTS

FULL FLOW SERIE

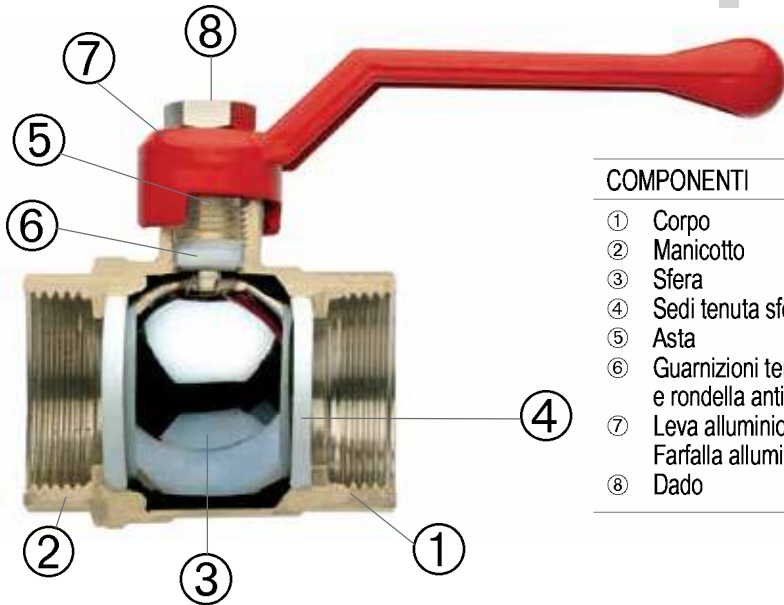

COMPONENTI	COMPONENTS	MATERIALI - MATERIALS
① Corpo	① Body	UNI EN 12165 CW617N
② Manicotto	② End connection	UNI EN 12165 CW617N
③ Sfera	③ Ball	UNI EN 12165 CW617N
④ Sedi tenuta sfera	④ Ball seal	P.T.F.E.
⑤ Asta	⑤ Stem	UNI EN 12164 CW614N
⑥ Guarnizioni tenuta asta e rondella antifrizione	⑥ Stem packing and antifriction ring	P.T.F.E.
⑦ Leva alluminio	⑦ Alu handle	AL fire painted
Farfalla alluminio	Butterfly handle	AL fire painted
⑧ Dado	⑧ Nut	Chrome plated Brass

Condizioni d'esercizio: Temperatura: min -15, max +120 - Pressione nominale: max 40 bar.

Working details: Temperature: min -15, max +120 - Nominal pressure: max 40 bar.

- Passaggio: totale
- Gamma: da 3/8" a 4"
- Attacco femmina: filettatura ISO 228/1 (DIN 259)
- Attacco maschio: filettatura ISO 228/1 (DIN 259)
- Codolo e dado: filettatura ISO 228/1 (DIN 259)

- Flow: full
- Range: from 3/8" till 4"
- Female thread: threading ISO 228/1 (DIN 259)
- Male thread: threading ISO 228/1 (DIN 259)
- Connection fitting and nut: threading ISO 228/1 (DIN 259)

Diagramma perdite di carico/portata
Load losses/flow rate graph

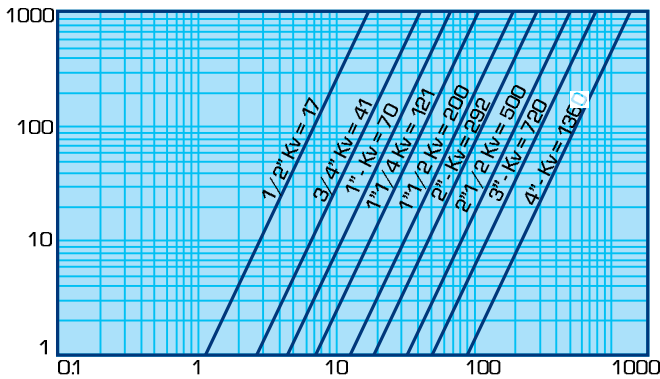

Portata = m³/h di Acqua
Water flow rate = m³/h

Diagramma pressione/temperatura
Pressure/temperature graph

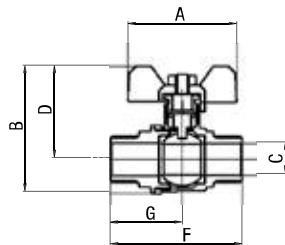
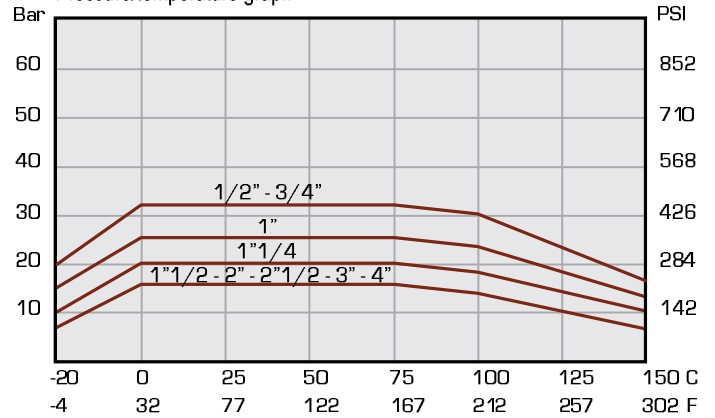

365 MM 1/2 €5,30 3/4 €7,50 1" €12,40

Valvola a sfera M.M., a passaggio totale, maniglia a farfalla.
C.P. full-flow ball valve M.M. with T handle.

	A	B	C	D	E	F	G
1/2"	58,5	53	14,5	38	51	60,5	33
3/4"	61	57,8	18,5	40,5	51	68,5	35,5
1"	71	68,8	23,5	47,8	62	78	40

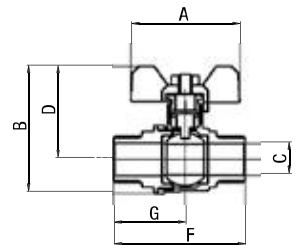

366 1/2 €6,30 3/4 €8,70 1" €14,50 1 1/4 €24,90

Valvola a sfera con bocchettone, a passaggio totale, maniglia a farfalla.
C.P. full-flow ball valve with union connection.

	A	B	C	D	E	F	G
1/2"	78	55	14	38	58	73	48
3/4"	85	60	19	42	58	82	55
1"	98	70	25	45	58	98	65
1 1/4"	110	87	25	60	77	110	72

VALVOLE - VALVES

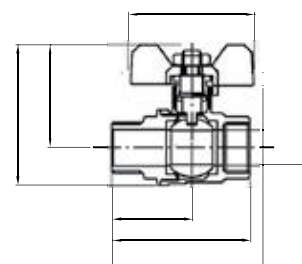
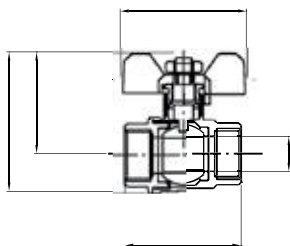

365 FF 1/2" € 4,80 3/4" € 6,60 1" € 10,90

Valvola a sfera F.F., a passaggio totale, maniglia a farfalla.
C.P. full-flow ball valve F.F. with T handle.

	A	B	C	D	E	F	G
1/2"	50	55	14	40		48	
3/4"	50	59	19	42		56	
1"	66	69	25	49		65	

365 MF 1/2" € 5,10 3/4" € 6,90 1" € 11,50

Valvola a sfera M.F., a passaggio totale, maniglia a farfalla.
C.P. full-flow ball valve M.F. with T handle.

	A	B	C	D	E	F	G
1/2"	68	55	14	40	58	57	34
3/4"	65	60	19	43	58	64	37
1"	72	67	24	48	66	72	41

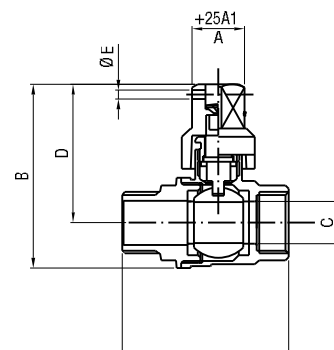
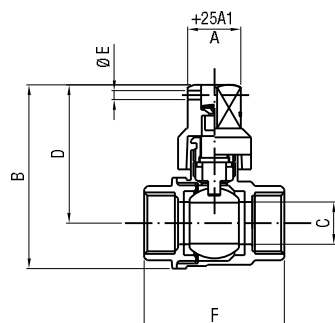

373 FF 1/2" € 5,50 3/4" € 7,60 1" € 11,80

Valvola a sfera F.F., a passaggio totale con quadro 13x13 bloccante piombabile.
C.P. full-flow ball valve F.F. with square cap 13x13.

	A	B	C	D	E	F	G
1/2"	14	63	14	47	3,2	48	
3/4"	14	68	19	50	3,2	56	
1"	16	75	24	53	3,2	65	

373 MF 1/2" € 6,30 3/4" € 8,40 1" € 12,90

Valvola a sfera M.F., a passaggio totale con quadro 13x13 bloccante piombabile.
C.P. full-flow ball valve M.F. with square cap 13x13.

	A	B	C	D	E	F	G
1/2"	14	65	14	47	3,2	64	
3/4"	14	68	19	50	3,2	63	
1"	16	75	24	53	3,2	71	

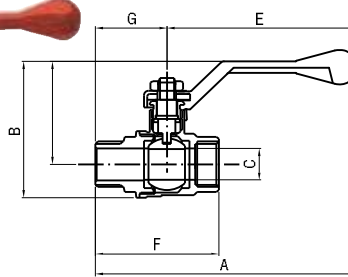
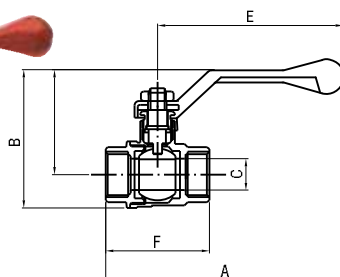

371 3/8" € 3,80 1/2" € 4,80 3/4" € 6,60 1" € 10,90 1 1/4" € 17,30
1 1/2" € 25,20 2" € 37,80 2 1/2" € 82,50 3" € 106,40 4" € 189,70

Valvola a sfera F.F., a passaggio totale, maniglia a leva.
C.P. full-flow ball valve F.F. with lever handle.

	A	B	C	D	E	F	G
3/8"	96	50	10	38	76	40	
1/2"	110	57	14	42	85	48	
3/4"	113	66	19	50	85	56	
1"	130	75	24	52	98	65	
1 1/4"	155	90	31	68	115	78	
1 1/2"	178	110	39	80	130	95	
2"	183	123	50	85	132	102	
2 1/2"	296	170	60	110	225	136	
3"	305	180	70	120	230	150	
4"	320	205	90	135	230	190	

370 1/2" € 5,10 3/4" € 6,90 1" € 11,50
1 1/4" € 18,70 1 1/2" € 24,90 2" € 38,80

Valvola a sfera M.F., a passaggio totale, maniglia a leva.
C.P. full-flow ball valve M.F. with lever handle.

	A	B	C	D	E	F	G
1/2"	117	58	14	43	85	57	34
3/4"	120	62	19	44	85	63	37
1"	135	75	24	53	96	72	41
1 1/4"	165	93	30	68	118	88	50
1 1/2"	186	110	40	80	132	98	56
2"	195	125	50	83	132	112	62

MINUTERIA
MINUTERY

VALVOLE
VALVES

RACCORDERIA
FITTINGS

ACCESSORI
ACCESSORIES

COMPONENTI PLASTICI
PLASTIC COMPONENTS

STANDARD SERIE

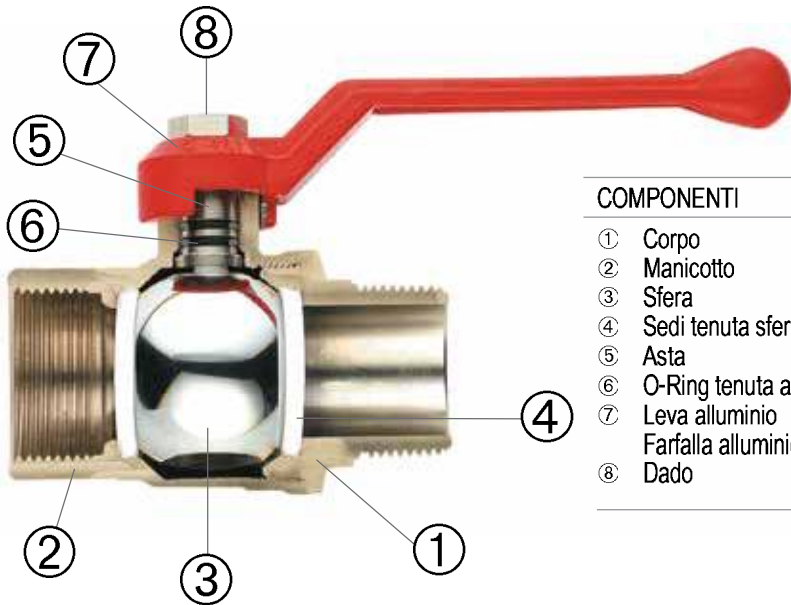

COMPONENTI	COMPONENTS	MATERIALI - MATERIALS
① Corpo	① Body	UNI EN 12165 CW617N
② Manicotto	② End connection	UNI EN 12165 CW617N
③ Sfera	③ Ball	UNI EN 12165 CW617N
④ Sedi tenuta sfera	④ Ball seal	P.T.F.E.
⑤ Asta	⑤ Stem	UNI EN 12164 CW614N
⑥ O-Ring tenuta asta	⑥ Rod seal O-Ring	NBR 70 Sh A (ASTM D 2240)
⑦ Leva alluminio	⑦ Alu handle	AL fire painted
Farfalla alluminio	Butterfly handle	AL fire painted
⑧ Dado	⑧ Nut	Chrome plated Brass

Condizioni d'esercizio: Temperatura: min -15, max +120 - Pressione nominale: max 40 bar.

Working details: Temperature: min -15, max +120 - Nominal pressure: max 40 bar.

- Passaggio: standard
- Gamma: da 1/2" a 2"
- Attacco femmina: filettatura ISO 228/1 (DIN 259)
- Attacco maschio: filettatura ISO 228/1 (DIN 259)

- Flow: standard
- Range: from 1/2" to 2"
- Female thread: threading ISO 228/1 (DIN 259)
- Male thread: threading ISO 228/1 (DIN 259)

Diagramma perdite di carico/portata
Load losses/flow rate graph

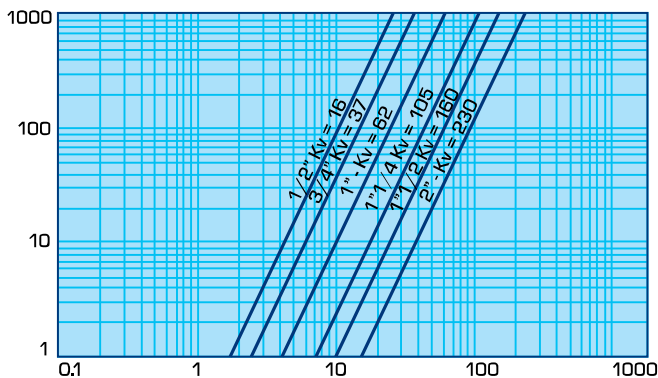

Portata = m³/h di Acqua
Water flow rate = m³/h

Diagramma pressione/temperatura
Pressure/temperature graph

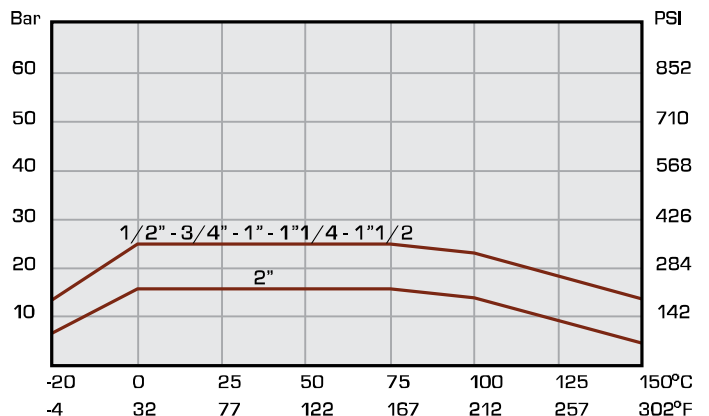

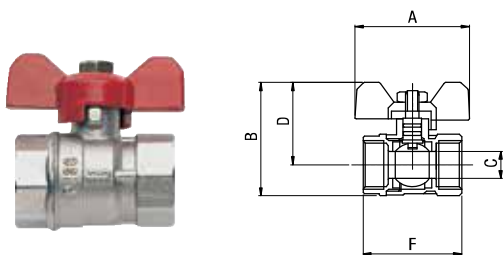

363 FF 1/2" €4,10 3/4" €5,60 1" €10,50

Valvola a sfera F.F., a passaggio standard, maniglia a farfalla, 1/2, 3/4, 1".
C.P. standard-flow ball valve F.F. with T handle, 1/2, 3/4, 1".

	A	B	C	D	E	F	G
1/2"	47	50	13,5	36	50	45	
3/4"	52	59	18	42	50	52	
1"	64	72	23	51	65	63	

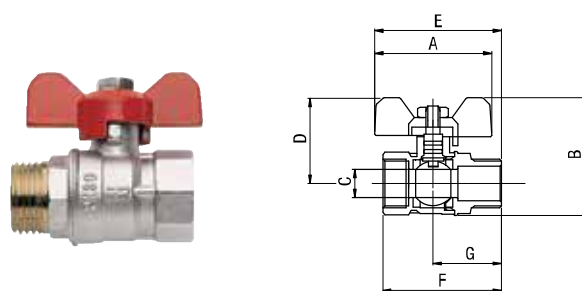

363 MF 1/2" €4,40 3/4" €6,20 1" €10,90

Valvola a sfera M.F., a passaggio standard, maniglia a farfalla, 1/2, 3/4, 1".
C.P. standard-flow ball valve M.F. with T handle, 1/2, 3/4, 1".

	A	B	C	D	E	F	G
1/2"	47	50	13,5	36	50	45	
3/4"	52	59	18	42	50	52	
1"	64	72	23	51	65	63	

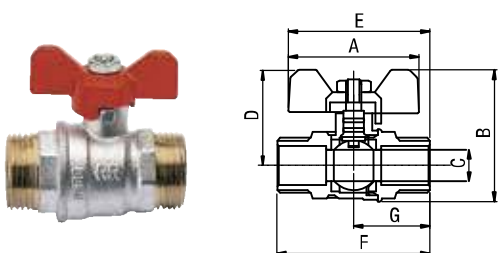

363 MM 1/2" €4,60 3/4" €6,40 1" €11,40

Valvola a sfera M.M., a passaggio standard, maniglia a farfalla, 1/2, 3/4, 1".
C.P. standard-flow ball valve M.M. with T handle, 1/2, 3/4, 1".

	A	B	C	D	E	F	G
1/2"	51,5	51,8	13,8	37	54,6	53	29,2
3/4"	51,5	58,5	17,8	41	58,5	59,5	32,8
1"	63	71,5	23,5	50	71,3	77,5	40,5

REDUCE FLOW SERIE

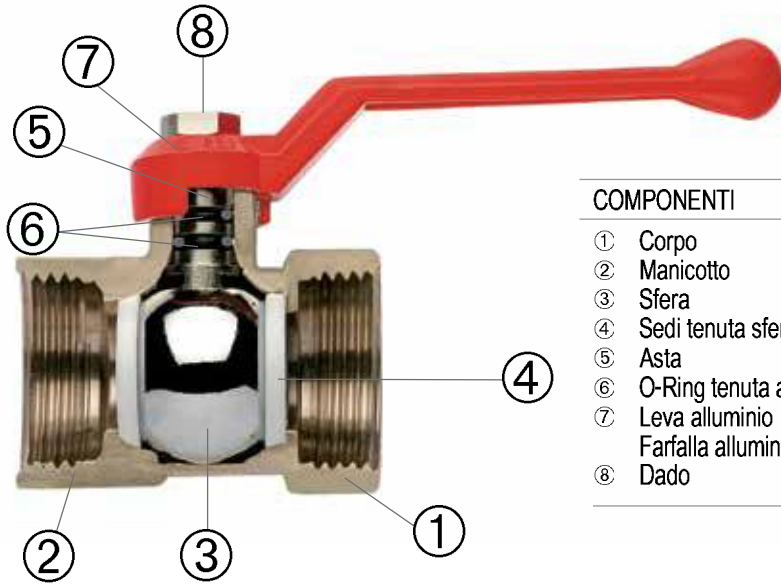

COMPONENTI	COMPONENTS	MATERIALI - MATERIALS
① Corpo	① Body	UNI EN 12165 CW617N
② Manicotto	② End connection	UNI EN 12165 CW617N
③ Sfera	③ Ball	UNI EN 12165 CW617N
④ Sedi tenuta sfera	④ Ball seal	P.T.F.E.
⑤ Asta	⑤ Stem	UNI EN 12164 CW614N
⑥ O-Ring tenuta asta	⑥ Rod seal O-Ring	NBR 70 Sh A (ASTM D 2240)
⑦ Leva alluminio	⑦ Alu handle	AL fire painted
Farfalla alluminio	Butterfly handle	AL fire painted
⑧ Dado	⑧ Nut	Chrome plated Brass

Condizioni d'esercizio: Temperatura: min -15, max +120 - Pressione nominale: max 40 bar.

Working details: Temperature: min -15, max +120 - Nominal pressure: max 40 bar.

- Passaggio: ridotto
- Gamma: da 1/2" a 4"
- Attacco femmina: filettatura ISO 228/1 (DIN 259)
- Attacco maschio: filettatura ISO 228/1 (DIN 259)

- Flow: reduced
- Range: from 1/2" to 4"
- Female thread: threading ISO 228/1 (DIN 259)
- Male thread: threading ISO 228/1 (DIN 259)

Diagramma perdite di carico/portata
Load losses/flow rate graph

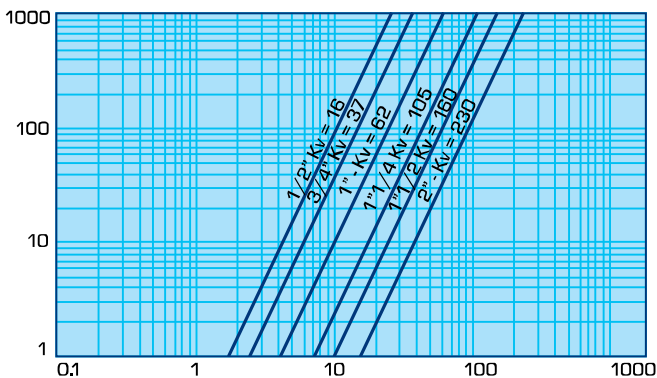

Portata = m³/h di Acqua
Water flow rate = m³/h

Diagramma pressione/temperatura
Pressure/temperature graph

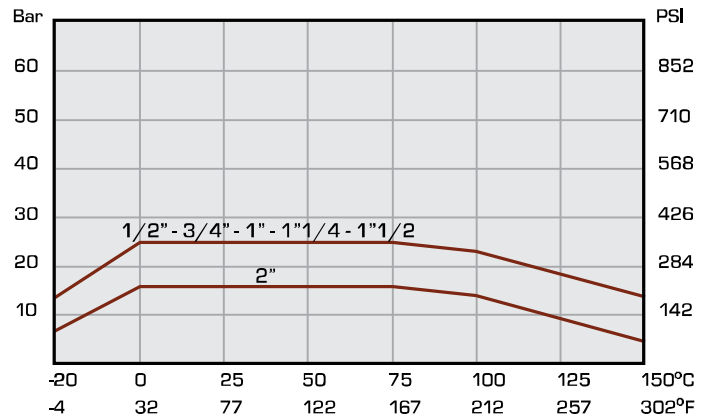

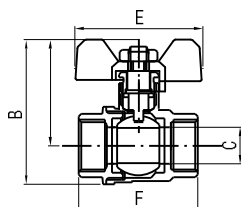

368 FF 1/2" € 4,00 3/4" € 5,70 1" € 9,50

Valvola a sfera F.F. maniglia a farfalla.
C.P. ball valve F.F., with T handle.

	A	B	C	D	E	F	G
1/2"		47		33	58	44	
3/4"		53		36	58	48	
1"		61		42	67	60	

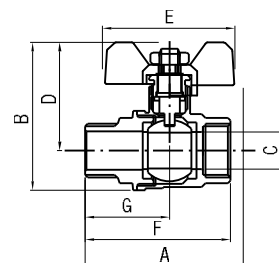

368 MF 1/2" € 4,20 3/4" € 6,00

Valvola a sfera F.F. maniglia a farfalla.
C.P. ball valve F.F., with T handle.

	A	B	C	D	E	F	G
1/2"	61	46	12	33	58	53	32
3/4"	64	53	15	36	58	58	34

VALVES

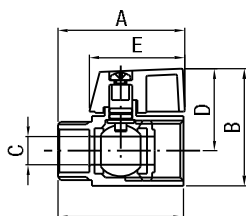

372 MF 1/4 €4,00 3/8 €4,10 1/2 €4,30

Valvola minisfera M.F., con maniglia nera.
C.P. mini ball valve M.F. with black handle.

	A	B	C	D	E	F	G
1/4"	42	38	7,5	28	33	41	
3/8"	42	38	8	28	33	41	
1/2"	45	40	10	28	33	44	

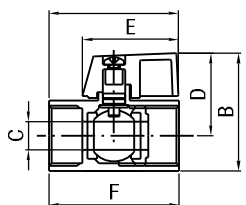

372 FF 1/4 €4,30 3/8 €4,40 1/2 €4,80

Valvola minisfera F.F., con maniglia nera.
C.P. mini ball valve F.F. with black handle.

	A	B	C	D	E	F	G
1/4"	44	38	7,5	28	33	42	
3/8"	44	38	8	28	33	42	
1/2"	45	40	10	28	33	45	

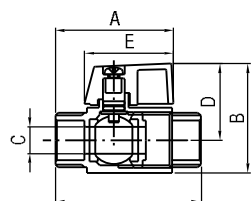

372 MM 1/4 €4,90 3/8 €5,10 1/2 €6,00

Valvola minisfera M.M., con maniglia nera.
C.P. mini ball valve M.M. with black handle.

	A	B	C	D	E	F	G
1/4"	42	38	7,5	28	33	54	
3/8"	42	38	8	28	33	55	
1/2"	45	40	10	28	33	59	

Condizioni d'esercizio: Temperatura: min -15, max +120 - Pressione nominale: max 10 bar.
Working details: Temperature: min -15, max +120 - Nominal pressure: max 10 bar.



372 MF NC 1/2 €4,60

Valvola minisfera M.F. maniglia cromata e nera, 1/2.
C.P. mini ball valve M.F. with two handles chromed and black, 1/2.



372 FF NC 1/2 €5,10

Valvola minisfera F.F. maniglia cromata e nera, 1/2.
C.P. mini ball valve F.F. with two handles chromed and black, 1/2.



372 MF RB 1/2 €4,60

Valvola minisfera M.F. maniglia rossa e blu, 1/2.
C.P. mini ball valve M.F. with two handles red and blue, 1/2.



372 FF RB 1/2 €5,10

Valvola minisfera F.F. maniglia rossa e blu, 1/2.
C.P. mini ball valve F.F. with two handles red and blue, 1/2.



376 FI

1/2 €28,10

Valvola a sfera con filtro, attacchi per manometro e scarico, con raccordo girevole da 1/2.
Ball valve with filter and connections for manometer and drain, with swivelling nut 1/2.



376 NR

1/2 €24,00

Valvola a sfera con valvolina di non ritorno, con attacchi per manometro e scarico, con raccordo girevole da 1/2.
Ball valve with non return valve and connections for manometer and drain, with swivelling nut 1/2.

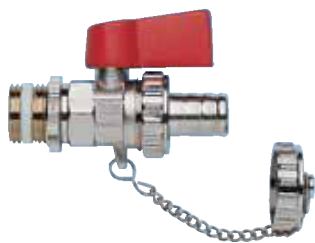
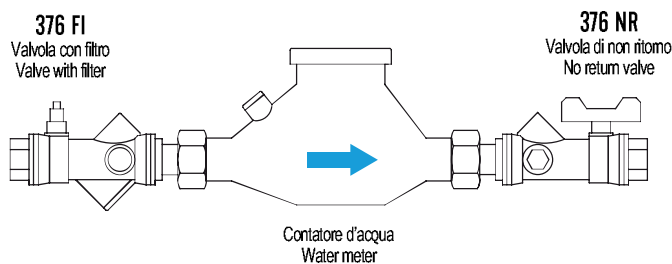

377

1/2 €6,90

Rubinetto scarico caldaia, a sfera, nichelato 1/2.
Drain cock male connection with plug, nickel plated, 1/2.

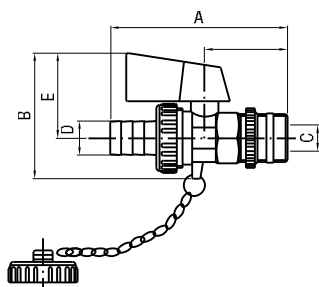

	A	B	C	D	E	F	G
1/2"	77	52	10	15	35	36	



377 OG

1/2 €6,60

Rubinetto scarico caldaia, a sfera, in ottone giallo 1/2.
Drain cock male connection with plug, brass finish, 1/2.

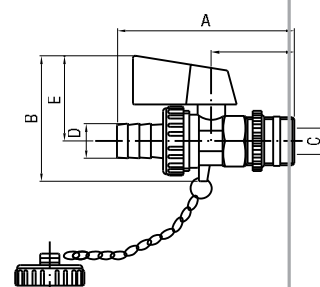

	A	B	C	D	E	F	G
1/2"	77	52	10	15	35	36	

Condizioni d'esercizio: Temperatura: min 0, max +80 - Pressione nominale: max 12 bar.
Working details: Temperature: min 0, max +80 - Nominal pressure: max 12 bar.

VALVOLE- VALVES

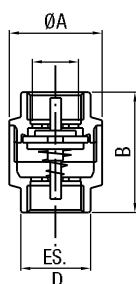

380

Valvola di ritegno.
REMER check valve.

1/2" € 4,70 1"1/4 € 13,20
3/4" € 6,90 1"1/2 € 20,00
1" € 9,20 2" € 30,50

	A	B	C	D	E	F	G
1/2"	35	45	19	25			
3/4"	40	48	24	32			
1"	47	56	30	37			
1" 1/4	59	61	39	46			
1" 1/2	67	70	45	53			
2"	83	75	55	67			

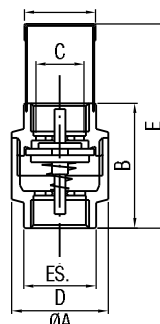

381

Valvola di fondo, con filtro.
REMER foot valve, with filter.

1/2" € 3,70 1"1/4 € 9,70
3/4" € 5,40 1"1/2 € 15,20
1" € 7,30 2" € 23,30

	A	B	C	D	E	F	G
1/2"	34	42	18	25	68	24	
3/4"	44	47	24	31	77	30	
1"	45	52	30	38	89	36	
1" 1/4	59	60	39	46	107	44	
1" 1/2	68	68	44	53	121	54	
2"	84	75	57	67	140	64	

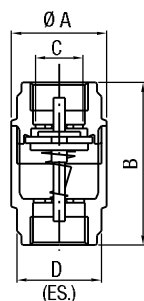

383

Valvola di ritegno STAR.
STAR check valve.

1/2" € 6,40 1"1/4 € 22,10
3/4" € 9,40 1"1/2 € 29,90
1" € 14,50 2" € 47,10

	A	B	C	D	E	F	G
1/2"	33	54	19	27			
3/4"	40	65	24	33			
1"	48	75	30	40			
1" 1/4	60	73	39	50			
1" 1/2	70	87	45	55			
2"	86	94	56	67			



384

Filtro per valvola STAR 1/2, 3/4,
1", 1"1/4, 1"1/2, 2".
Filter for STAR check valve 1/2,
3/4, 1", 1"1/4, 1"1/2, 2".

1/2 € 1,30 1"1/4 € 2,00
3/4 € 1,50 1"1/2 € 2,50
1" € 1,60 2" € 3,20

Condizioni d'esercizio: Temperatura: min 0, max +80 - Pressione nominale: max 12 bar.
Working details: Temperature: min 0, max +80 - Nominal pressure: max 12 bar.



385

Valvola di ritegno.
Foot valve, measures from 3/4 to 2".

3/4" € 9,30 1"1/2 € 22,30
1" € 11,70 2" € 33,90
1"1/4 € 18,30



388

Valvola a clapet con tenuta gomma, 1/2", 3/4", 1".
Swing check valve, with rubber sealing, from 1/2"
to 1".

1/2" € 8,80 1" € 19,20
3/4" € 13,80

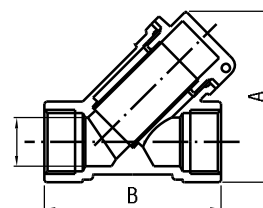

389

Filtro a "Y" in ottone, con rete 400 micron.
"Y" brass filter, with 400 micron strainer.

1/2" € 4,60 1"1/4 € 18,10
3/4" € 7,10 1"1/2 € 27,20
1" € 10,10 2" € 44,20

	A	B	C	D	E	F	G
1/2"	63	55	15				
3/4"	67	70	20				
1"	75	76	25				
1" 1/4	89	99	32				
1" 1/2	100	107	40				
2"	125	126	50				

Condizioni d'esercizio: Temperatura: min 0, max +100 - Pressione nominale: max 20 bar.
Working details: Temperature: min 0, max +100 - Nominal pressure: max 20 bar.

VALVOLE - VALVES

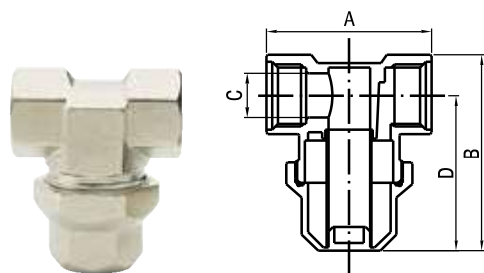

390 FF 1/2 €10,70 3/4 €16,20

Filtro di linea in ottone nichelato, con rete 400 micron, F.F.
In-line filter in nickel-plated brass, with 400 micron strainer, F.F.

	A	B	C	D	E	F	G
1/2"	60	70	13,5	54			
3/4"	71	74	18	55			

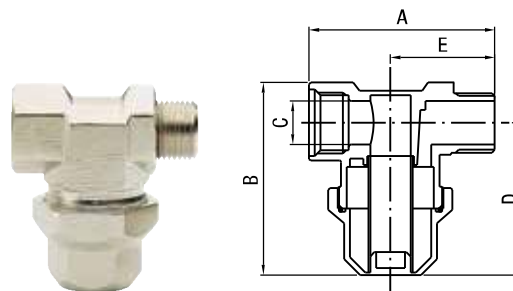

390 MF 1/2 €10,70 3/4 €16,20

Filtro di linea in ottone nichelato, con rete 400 micron, M.F.
In-line filter in nickel-plated brass, with 400 micron strainer, M.F.

	A	B	C	D	E	F	G
1/2"	66	70	13,5	54	36		
3/4"	74	72	18	54	40		

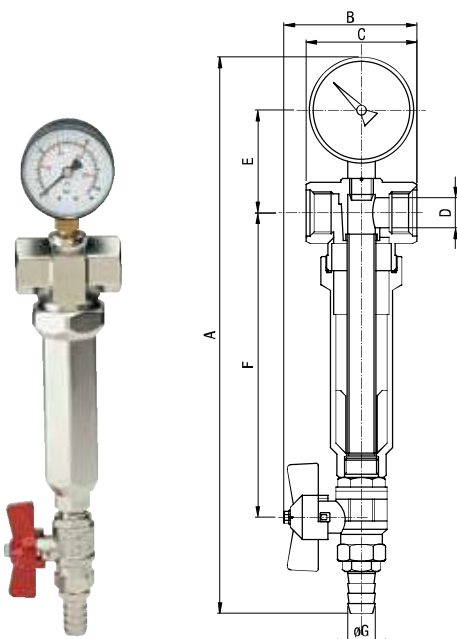

392 1/2 €40,40 3/4 €49,90

Filtro autopulente per fluidi, con rete 100 micron, 1/2, 3/4.
Self-cleaning filter for fluids, 100 micron strainer, 1/2, 3/4.

	A	B	C	D	E	F	G
1/2"	290	70	60	19	60	157	14
3/4"	290	77	60	24	62	150	14



397 €1,30

Tubo gas a norme UNI CIG 7140 - IMQ, Ø 8x13, per gas liquido GPL, in rotoli da mt 50.
Tube for liquid gas GPL, UNI CIG 7140 and IMQ standard rules, Ø 13x8mm, in rolls of 50 meters.



398 €2,20

Tubo gas a norme UNI CIG 7140 - IMQ, Ø 13x20, per gas METANO, in rotoli da mt 50.
Tube for natural gas, UNI CIG 7140 and IMQ standard rules, Ø 13x20 mm, in rolls of 50 meters.

MINUTERIA
MINUTERY

VALVOLE
VALVES

RACCORDERIA
FITTINGS

ACCESSORI
ACCESSORIES

COMPONENTI PLASTICI
PLASTIC COMPONENTS

YELLOW SERIE



400 FF

Tubo flessibile per gas, FF, conforme alla norma EN14800, tubo interno in acciaio inox, ricoperto da trecciatura inox e rivestito da una guaina in pvc.
Flexible tube for gas, FF, conform to EN14800, internal tube in stainless steel, external braided in stainless steel and covered in pvc.

cm	50	75	100	125	150	200
	€ 25,00	€ 29,50	€ 31,90	€ 34,80	€ 35,80	€ 37,50



400 MF

Tubo flessibile per gas, MF, conforme alla norma EN14800, tubo interno in acciaio inox, ricoperto da trecciatura inox e rivestito da una guaina in pvc.
Flexible tube for gas, MF, conform to EN14800, internal tube in stainless steel, external braided in stainless steel and covered in pvc..

cm	50	75	100	125	150	200
	€ 25,00	€ 29,50	€ 31,90	€ 34,80	€ 35,80	€ 37,50



400 FF RI

prodotto non vendibile in italia

Tubo gas inox estensibile ricoperto in polietilene termoretraibile a norma UNI CIG 9891 con marchio IMQ, per collegamento di apparecchiature domestiche.
Flexible extensible stainless steel hose, suitable for domestic use gas connections, in accordance with UNI-CIG 9891, IMQ, covered with yellow thermoshrinking sleeving.

1/2 FF	50-100 cm	75-150 cm	100-200 cm
	€18,30	€ 22,00	€ 25,70



400 MF RI

prodotto non vendibile in italia

Tubo gas inox estensibile ricoperto in polietilene termoretraibile a norma UNI CIG 9891 con marchio IMQ, per collegamento di apparecchiature domestiche.
Flexible extensible stainless steel hose, suitable for domestic use gas connections, in accordance with UNI-CIG 9891, IMQ, covered with yellow thermoshrinking sleeving .

1/2 MF	50-100 cm	75-150 cm	100-200 cm
	€18,30	€ 22,00	€ 25,70



440

Tubo inox estensibile antivibrante, adatto per gas, acqua, olii, acidi, aria, vapore.
Stainless steel extensible anti-vibration pipe, suitable for gas, water, oils, acids, air, steam.

	Lunghezza - Length mm 110-210	Lunghezza - Length mm 200-410
1/2 MF	€ 9,80	€ 11,80
3/4 MF	€ 14,20	€ 16,50
1" MF	€ 20,50	€ 22,50



440 RI

Tubo inox estensibile rivestito in polietilene termoretraibile.
Stainless steel extensible pipe, covered with heat-shrinkable polyethylene.

	Lunghezza - Length mm 110-210	Lunghezza - Length mm 200-410
1/2 MF	€12,40	€ 15,00
3/4 MF	€16,80	€ 20,70

VALVOLE - VALVES



400 GU €0,08
Guamizione in alluminio, 1/2 per art. 400.
Washer in aluminium, 1/2 for art. 400.



400 RA €9,20
Raccordo maschio da 1/2".
Rackord male 1/2" for art. 400.



400 CH €4,50
Maniglia con filetto da 1/2" maschio per estendere l'art. 400, più chiave di fissaggio.
Lever with 1/2" male thread to extend art. 400 and its fixing key.

MINUTERIA
MINUTERY

VALVOLE
VALVES

RACCORDERIA
FITTINGS

ACCESSORI
ACCESSORIES

COMPONENTI PLASTICI
PLASTIC COMPONENTS



401 1/2 €17,10
Rubinetto a sfera a squadra per gas metano, cromato M, 1/2.
C.P. angle ball valve for natural gas, 1/2M.



402 1/2 €17,10
Rubinetto a sfera a squadra per gas metano, cromato F, 1/2.
C.P. angle ball valve for natural gas, 1/2F.



403 1/2 €17,10
Rubinetto a sfera a squadra per gas liquido GPL, cromato M, 1/2.
C.P. angle ball valve for liquid gas GPL, 1/2M.



404 1/2 €17,10
Rubinetto a sfera a squadra per gas liquido GPL, cromato F, 1/2.
C.P. angle ball valve for liquid gas GPL, 1/2F.



405 1/2 €17,10
Rubinetto a sfera dritto per gas metano, cromato M, 1/2.
C.P. straight ball valve for natural gas, 1/2M.



406 1/2 €17,10
Rubinetto a sfera dritto per gas metano, cromato F, 1/2.
C.P. straight ball valve for natural gas, 1/2F.



407 1/2 €17,10
Rubinetto a sfera dritto per gas liquido GPL, cromato M, 1/2.
C.P. straight ball valve for liquid gas GPL, 1/2M.



408 1/2 €17,10
Rubinetto a sfera dritto per gas liquido GPL, cromato F, 1/2.
C.P. straight ball valve for liquid gas GPL, 1/2F.



399 1/2 €9,30
Rubinetto gas a sfera a squadra passaggio mm 12,5 con maniglia a farfalla, 1/2 MM.
Angle ball valve for natural gas with T handle, flow Ø 12,5, 1/2M.



411 M 1/2 €14,20
Rubinetto a sfera a squadra per gas, con dado girevole, cromato, M 1/2.
C.P. angle ball valve for gas, with swivelling nut, M 1/2.



411 F 1/2 €14,20
Rubinetto a sfera a squadra per gas, con dado girevole, cromato, F 1/2.
C.P. angle ball valve for gas, with swivelling nut, F 1/2.



COMPANY PROFILE



**TUTTA LA FORZA DI UN GRANDE GRUPPO
ALL THE STRENGTH OF A BIG GROUP**



TUTTA LA FORZA DEL MADE IN ITALY

THE MADE IN ITALY STARTS HERE

TECNOLOGIE ED INVESTIMENTI

Il Gruppo Remer è da sempre alla ricerca di sviluppo e tecnologia e soprattutto negli ultimi anni questo processo ha avuto un incremento notevole che ha portato alla nascita di nuovi stabilimenti di produzione con lo scopo di accentrare tutte le fasi produttive.

All'interno del nostro gruppo si trovano macchinari di ultima generazione che permettono di realizzare il prodotto finito.

Parliamo di cicli completi che vanno dalla progettazione alla realizzazione dei manufatti, tutto all'interno dei nostri stabilimenti.

Possiamo elencare i nostri macchinari più sofisticati quali (ma non solo):

- numerosi centri di lavoro con robots,
- numerosi centri di lavoro con visori ottici e robots,
- svariate transfer a 3 assi,
- numerose transfer a doppia barra
- torni con caricatori in grande quantità,
- macchinari per il taglio barra piena o forata e in tubo,
- macchinari per il taglio tubi e lavorazione canotti e aste
- impianti per il taglio della lastra di ottone o altri metalli,
- grande dipartimento di stampaggio plastica con numerose macchine multimarca.

TECHNOLOGY AND INVESTMENT

Remer Group has always been searching for innovation and technology and during the last few years this process had a remarkable acceleration that drove to the centralisation of all our production plants between Milan and Bergamo area, to group all our production phases and implement our logistics.

Inside these plants there are the most sophisticated Italian last generation machineries that permit to manufacture until the finished product.

Therefore we are talking about a complete cycle that goes from the design to the finished product.

We can list our sophisticated machineries like (but not only):

- several work stations with robots,
- many work stations with optical viewers and robots
- several 3-ways transfers- several robotised and automatic polishing machines,
- several double bar transfers
- many lathes with loaders
- full bar and tube bar cutters
- pipes cutters and machineries to process tubes and rods
- brass plate or other metals cutters
- forging and injection machines department



Grandi spazi completamente attrezzati con macchinari italiani di ultima generazione.

Large spaces fully equipped with the latest Italian machinery

In più:

- grande area dedicata alla lucidatura e pulitura con numerosi impianti automatici robotizzati e sistemi manuali,
- grande impianto di cromatura ad alta qualità,
- dipartimento per la creazione di stampi,
- grande e sofisticata area test prodotto e controllo qualità,
- spettrometro per analisi materia prima,
- svariate linee automatiche di confezionamento,
- impianti per insacchettamento in automatico,
- macchine taglio spugna,
- imballaggio in termoformato in automatico,
- linee automatiche di confezionamento.
- controllo e gestione della produzione e degli ordini totalmente automatizzata con stazioni pc e radio frequenza in tutti gli stabilimenti.

Furthermore:

- several robotised and automatic polishing machines
- high quality chrome plating system
- tooling and moulds creation laboratory
- sophisticated testing quality control machinery departments
- spectrometer for analysis of raw material
- several automatic packaging
- automatic bagging systems
- sponge-cutters
- thermo format machines
- automatic packaging systems,
- radio frequency automatic orders control in each department



TORNI CNC CON ISOLE ROBOTIZZATE

AUTOMATIC LATHES CNC WITH ROBOTISED ISLANDS



Un connubio perfetto tra l'alto livello di automazione
e la professionalità del nostro personale.

A perfect match between the high level of automation
and the professionalism of our staff

LAVORAZIONI INTERNE

INTERNAL WORKINGS



La precisione è la base dei nostri progetti e segue costantemente tutto il ciclo produttivo.

Precision is the base of our projects and constantly follows all the productive cycle.



La realizzazione dei manufatti è completamente automatizzata e controllata.

The production is totally automated and controlled



ENGINEERING 2:



TRANSFER E CENTRI DI LAVORO PER PRODOTTI FUSI E STAMPATI
TRANSFERS AND WORKING STATIONS FOR CASTED AND FORGED PRODUCTS



Tutta la forza produttiva di macchinari altamente all'avanguardia.

All the productive strength of highly advanced machinery.

TRANSFER AUTOMATICA A 9 STAZIONI CON ROBOT PER LAVORAZIONE CORPI FUSI E STAMPATI **9 STATIONS AUTOMATIC TRANSFER WITH ROBOT FOR PROCESSING CASTED AND FORGED BODIES**



Qualità, velocità e precisione: un macchinario che può lavorare simultaneamente su 9 stazioni lo stampato e il fuso

Quality, fastness and precision: a machine that can work simultaneously forged and casted on 9 stations



TRANSFER CON CARICO E LAVORAZIONE SIMULTANEA DI 2 BARRE DOUBLE BAR TRANSFER WITH LOAD AND SIMULTANEOUS WORKING OF 2 BARS



Precisione e velocità imbattibile per prodotti ad alto consumo



Precision and fastness, unbeatable for high consume products

CENTRI DI LAVORO CON ROBOT WORKING STATIONS WITH ROBOTS



**CARICO ROBOTIZZATO DEI PEZZI
PRODUCT ROBOTISED LOAD ON TRANSFER MACHINES**

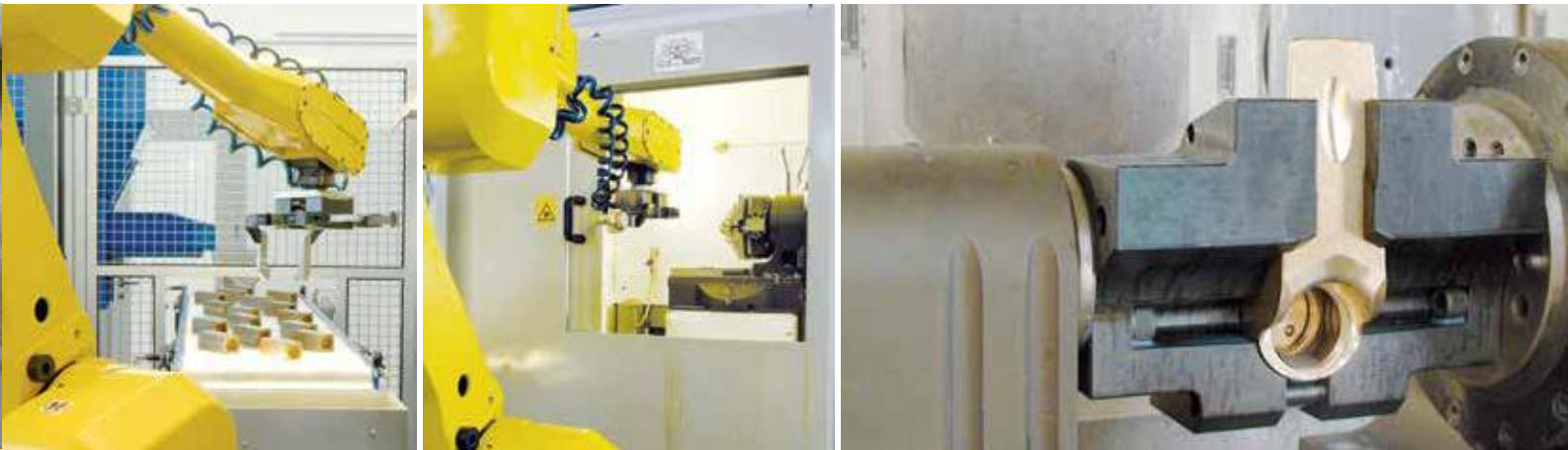

**TRANSFER ROBOTIZZATO CON VISORE OTTICO E RIBALTATORE
TRANSFER ROBOT WITH OPTICAL VISUALISER AND TIPPER**





**CICLO DI PRODUZIONE ASTE SALISCENDI E CANOTTI
SLIDING RAILS RODS, TUBES AND PIPES PRODUCTION CYCLE**



**MACCHINA AUTOMATICA PER PULITURA ASTE A TAVOLA ROTANTE
ROLLING TABLE RODS CLEANING AND POLISHING AUTOMATIC MACHINE**

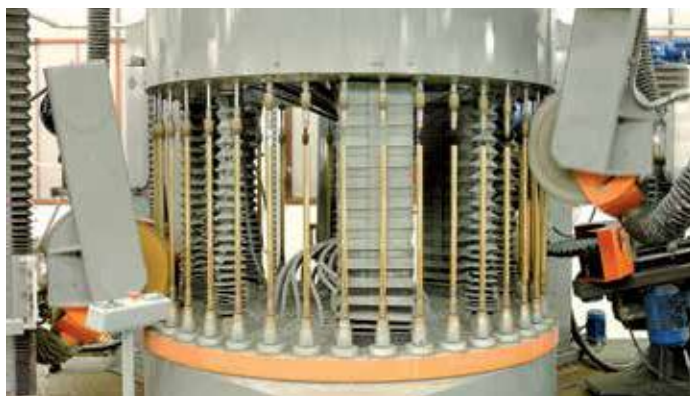

**REPARTO PULITURA
POLISHING DEPARTMENT**





**PULITURA E SMERIGLIATURA ROBOTIZZATA E MANUALE
ROBOT AND MANUAL POLISHING AND GRINDING PROCESS**



**MACCHINA PULITURA DOPPIA ROBOTIZZATA
DOUBLE ROBOT POLISHING MACHINE**



**BURATTATURA
TUMBLING**





TAGLIO LASTRA D'OTTONE
BRASS PLATE CUTTING



REPARTO CROMATURA
CHROME PLATING DEPARTMENT





**REPARTO TRECCIATURA TUBI
FLEXIBLE HOSES BRAIDING DEPARTMENT**



**PRE-ASSEMBLAGGIO AUTOMATICO COMPONENTI
COMPONENTS AUTOMATED PRE-ASSEMBLY**



**PRODUZIONE AUTOMATICA TUBI FLESSIBILI
FLEXIBLE HOSES AUTOMATED PRODUCTION**





**STAMPAGGIO MATERIALI PLASTICI
INJECTION PLASTIC MATERIAL PRESSING DEPARTMENT**

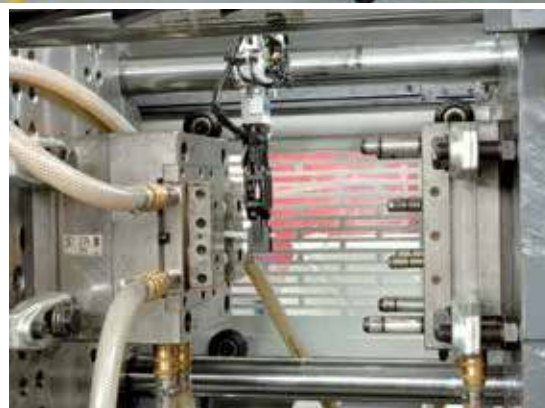



**CONTROLLO CROMATURA
CHROME PLATING CONTROL**



**CONTROLLO COMPOSIZIONE MATERIALI
RAW MATERIAL ANALYSI CONTROL**

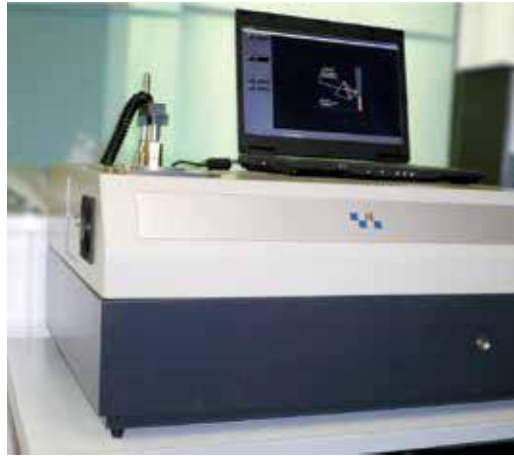

**PROTOTIPATRICE TRIDIMENSIONALE
THREE-DIMENSIONAL
PROTOTYPING MACHINE**

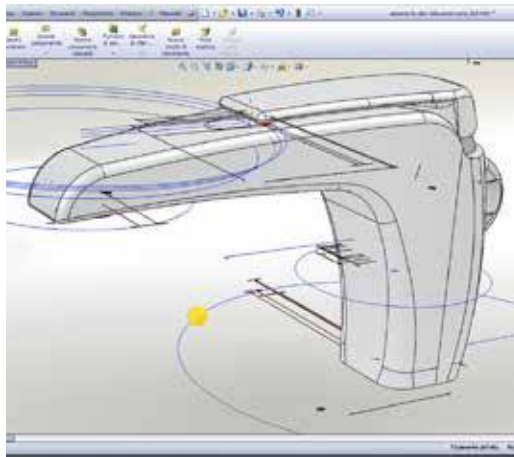

**MODELLO 3D
3D RENDER PROGRAM**

Deazione e progettazione sono supportate da una tecnologia innovativa di altissima qualità.
Design and projectual and practical creations are supported from a wide range of very innovative technologies

**RICERCA E SVILUPPO
RESEARCH AND DEVELOPMENT**





TÜV PROFICERT

CERTIFICATE

Management system as per
EN ISO 9001:2015

Evidence of conformity with the above standard(s) has been furnished
and is certified in accordance with TÜV PROFICERT procedures for

REMER RUBINETTERIE S.p.A.
Via Leonardo da Vinci, 83
I - 20062 Cassano D'Adda (MI)

scope:
Design, production and sale of taps and fittings, hydraulic
items, accessories and complements for bathroom and kitchen.
Scope: 18G02 (E.A: 17/2)

Certificate registration No. 73 100 2281	Certificate valid from 2017-04-11 to 09/08/2020
Audit report No. 4320 5576	First certification 2008-03-07

PAGE 1 OF 1
 This certification was conducted in accordance with the TÜV PROFICERT audit and certification procedures and is subject to regular surveillance audits. The holder undertakes to take all necessary measures to ensure conformity with the requirements of the standard(s) and to report any changes to the certification body. TÜV Technische Überwachung Hessen GmbH, Rüdigerstr. 119, D-64285 Darmstadt, Tel. +49 6181 6000331, Fax +49 6181 31301

TÜV PROFICERT

CERTIFICATE

Management system as per
EN ISO 14001:2015

Evidence of conformity with the above standard(s) has been furnished
and is certified in accordance with TÜV PROFICERT procedures for

REMER RUBINETTERIE S.p.A.
Via Leonardo da Vinci, 83
I - 20062 Cassano D'Adda (MI)

scope:
Design, production and sale of taps and fittings, hydraulic
items, accessories and complements for bathroom and kitchen.
Scope: 17R4 (E.A: 17/2)

Certificate registration No. 73 104 2281	Certificate valid from 2017-04-20 to 09/08/2020
Audit report No. 4320 5576	First certification 2008-03-07

PAGE 1 OF 1
 This certification was conducted in accordance with the TÜV PROFICERT audit and certification procedures and is subject to regular surveillance audits. The holder undertakes to take all necessary measures to ensure conformity with the requirements of the standard(s) and to report any changes to the certification body. TÜV Technische Überwachung Hessen GmbH, Rüdigerstr. 119, D-64285 Darmstadt, Tel. +49 6181 6000331, Fax +49 6181 31301

TÜV PROFICERT

CERTIFICATO

per il sistema di gestione secondo
EN ISO 9001:2015

La prova della conformità alla norma sopra indicata è stata fornita
e viene documentata secondo le procedure TÜV PROFICERT per

REMER RUBINETTERIE S.p.A.
Via Leonardo da Vinci, 83
I - 20062 Cassano D'Adda (MI)

Campo di applicazione:
Progettazione, produzione e vendita di rubinetteria, articoli per
idraulica, accessori e complementi per bagno e cucina
Scopo: 18G02 (E.A: 17/2)

N° registrazione certificato 73 100 2281	Certificato valido da 2017-04-11 a 09/08/2020
Rapporto di Audit: 4320 5576	Prima certificazione 2008-03-07

PAGINA 1 DI 1
 Questa certificazione è stata eseguita secondo le procedure TÜV PROFICERT per verificare e certificare la conformità a norme, direttive, regolamenti, leggi, decreti, circolari, ordinanze, etc. Il titolare si impegna a mantenere la conformità alle norme e a segnalare qualsiasi cambiamento. TÜV Technische Überwachung Hessen GmbH, Rüdigerstr. 119, D-64285 Darmstadt, Tel. +49 6181 6000331, Fax +49 6181 31301

TÜV PROFICERT

CERTIFICATO

per il sistema di gestione secondo
EN ISO 14001:2015

La prova della conformità alla norma sopra indicata è stata fornita
e viene documentata secondo le procedure TÜV PROFICERT per

REMER RUBINETTERIE S.p.A.
Via Leonardo da Vinci, 83
I - 20062 Cassano D'Adda (MI)

Campo di applicazione:
Progettazione, produzione e vendita di rubinetteria, articoli per
idraulica, accessori e complementi per bagno e cucina
Scopo: 17R4 (E.A: 17/2)

N° registrazione certificato 73 104 2281	Certificato valido da 2017-04-20 a 09/08/2020
Rapporto di Audit: 4320 5576	Prima certificazione 2008-03-07

PAGINA 1 DI 1
 Questa certificazione è stata eseguita secondo le procedure TÜV PROFICERT per verificare e certificare la conformità a norme, direttive, regolamenti, leggi, decreti, circolari, ordinanze, etc. Il titolare si impegna a mantenere la conformità alle norme e a segnalare qualsiasi cambiamento. TÜV Technische Überwachung Hessen GmbH, Rüdigerstr. 119, D-64285 Darmstadt, Tel. +49 6181 6000331, Fax +49 6181 31301





Grazie!
Thank you!
